

## WHITE CAP FOR 6X6MM TACTILE SWITCHES - 10MM DIAMETER

Press fit to standard 6mm tactile switches for enclosure use.

### DIMENSIONS

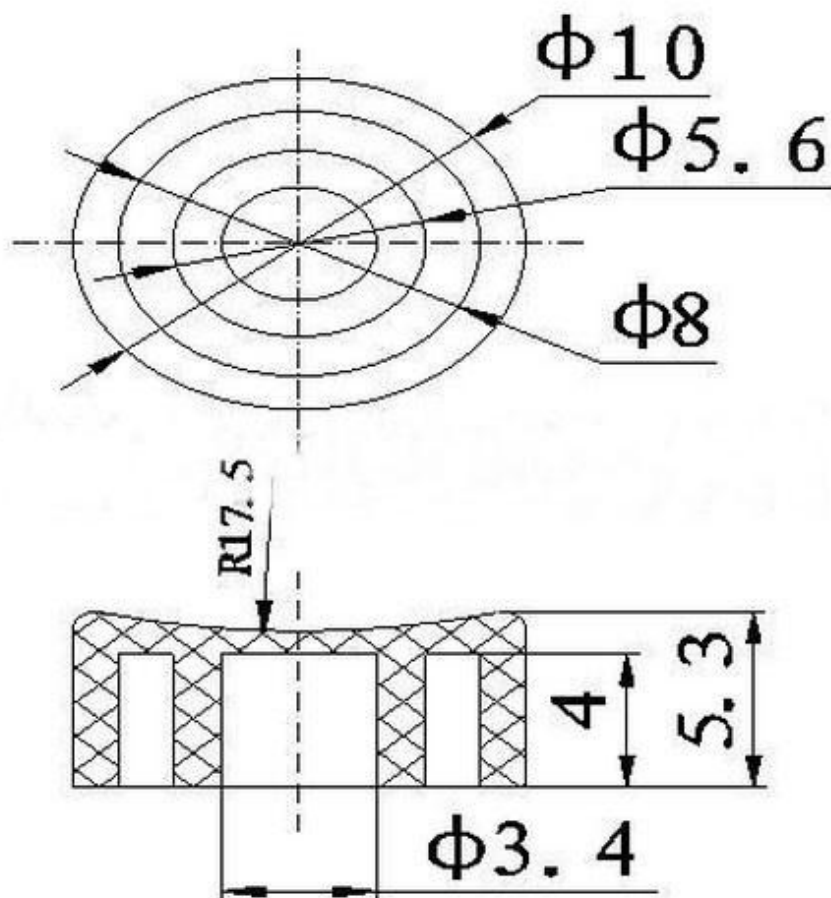

### SPECIFICATIONS

Product Name	Plastic Cap for Tactile Switch
Mounting Type	Press Fit (Adhesive drop recommended for production use)
Button Size	10mm Diameter, Curved Top
Material	ABS Plastic
Finish	Glossy

### ORDERING DETAILS

Sunrom Part#	Color	Ordering Page
4970	WHITE	<a href="http://www.sunrom.com/m/4970">http://www.sunrom.com/m/4970</a>